

ShowMakers of America

Contest 2012

Dear Director,

It is our great pleasure to welcome you to **ShowMakers® Contest Season 2012!**

We are very excited about the quality of schools competing in our contest and are especially pleased to have **YOU** attend.

This is your contest information booklet that contains pertinent information regarding each contest location. Please **read it** carefully, as it will answer most questions that you may have. Should you have additional questions, our office hours are Monday-Friday 10:00 a.m. - 5:00 p.m. (but we can be reached through e-mail all of the time). **Please note contest specifics for the Texas State Championship on page 7.*

Directors, we know how hard you have worked preparing for contest. We want to assure you of our commitment to providing you with the most organized, fair and prestigious competition in the nation.

Please e-mail our office if you need assistance or have questions!

Warmest regards,

Susan Angell-Gonzalez

Susan Angell-Gonzalez

President/CEO

Susan Angell Enterprises, Inc.

Headquarters – San Marcos

susan@showmakerscamps.com

Stacy Becker

Stacy Becker

Vice President

ShowMakers of America®

San Antonio Office

stacy@showmakerscamps.com

GENERAL CONTEST INFORMATION

- TEAM REGISTRATION:** Teams must enter the area marked “Teams Only.” Members MUST be in costume or team uniform to be admitted free of charge. This policy will also apply to TEAM MANAGERS (NO EXCEPTIONS). One director and one assistant director will receive name badges (**Asst. Director: only if an additional name is received on the registration form or notify our office in advance via e-mail if an additional director will be attending**). Three VIP passes/wristbands for additional directors, chaperones and bus drivers will be given. Any person not in uniform, and/or who does not have a ticket, will have to pay admission. Please note the difference in wristbands for Friday and Saturday admission. Those groups participating both days will receive 2 sets of tickets. If your team is participating Saturday only, 3 VIP passes will be included. (Schools entering under 3 routines or only solos will receive 2 wristbands.) VIP Passes will not be given to individual entries. **Cost for admission: \$8.00 Friday / \$10.00 Saturday.** We ask that you inform all parents, friends, etc., of these charges. All spectators will enter through the area marked “Spectator Entrance.” Paid spectators will receive a wristband that must be worn throughout the duration of the contest. Anyone without a band will be escorted off the premises.
- All paying spectators will receive a complimentary contest program. Programs for participants will not be provided. Directors will be e-mailed a schedule in advance, that we recommend be Xeroxed for students and chaperones. A preliminary competition schedule will be **e-mailed** 3-5 days prior to the contest. All **changes in entry** must be made 10 days prior to the contest date. Schedule changes must be made immediately following receipt. All changes must be received in **writing** via e-mail! **Please direct all scheduling questions or conflicts (via e-mail) to Stacy Becker in our San Antonio office: stacy@showmakerscamps.com**. Final contest information will be **e-mailed** with the schedule. Due to the many changes received, we will not post the schedule online until the day prior to the contest.
- Registrations and fees:** ALL MONIES MUST BE RECEIVED PRIOR TO THE CONTEST DATE. ONLY SCHOOL CHECKS, PURCHASE ORDERS OR MONEY ORDERS WILL BE ACCEPTED. **ABSOLUTELY NO PERSONAL CHECKS ACCEPTED.** **► Teams will not be allowed to compete unless payment is received prior to the contest. We WILL take schools OFF the schedule that haven't paid by the contest date.** **► Absolutely no contest fees will be accepted at the door unless advance arrangements have been made through our office. Refunds will not be given if cancellations or schedule removals are made seven days prior to the contest. Please direct all bookkeeping questions via e-mail to: susan@showmakerscamps.com.**
- Music must be on CD's, tapes, Mp3 or I-pod only, and music device is to be labeled with school's name and routine category. Music tapes & CD's should be recorded to speed. A director or team representative must be at the sound table during the performance to operate Mp3/I-pod players, and with back-up music on hand to avoid potential delays. **It is best to record music to performance tempo no matter the device.** ShowMakers® will provide a high quality sound system, however, time can be saved if music is recorded to speed. If a speed adjustment is needed, we ask that you arrive early and meet with our sound tech. Keep in mind that most sound systems play tapes/CD's differently. **Be aware that the audio sessions burned/recorded on a personal computer (using a program that is selected to playback only on a personal computer), could cause a professional CD player to have difficulty in reading the disc and will display an error message. Please have a cassette tape as backup.** We ask that your music be at the sound table 20 minutes ahead of schedule. At the time of performance, have a **representative present** with a backup on hand. If using a tape, please make sure they are cued up and ready to play. One song should be on the recording without announcement. No entrance or exit music is allowed. Sound checks will only be played during

performance intervals/breaks. Headphones will be available for you to check music speed. **Variable speed CD/tape** players will be provided in all performance areas. ► **Please READ the attached CD burn/recording information.**

5. Teams/Officers/Ensembles/Soloists must be lined up 15 minutes prior to performance. Be prepared for the contest to run ahead of schedule! Inform parents and supporters that an early performance could happen. We have tried to allow as much costume change time as possible. Music for Teams/Officers/Ensembles is to be at the sound table 20 minutes ahead of schedule. Soloists may present their music upon performance. A director or team representative must be at the sound table during the performance to operate Mp3/I-pod players, and with back-up music on hand to avoid potential delays. Again, it is advisable to have a back-up **TAPE** on hand!

6. **Important:** When entering the solo, ensemble and officer division, please register all names online. **E-mail the ShowMakers®** office if you have question regarding online registration. This form is to alert us of any potential overlaps in performances. We will then be able to schedule routines as far apart as possible. When scheduling these categories, we try and block your group together. It becomes difficult when students perform in more than one ensemble, etc. Should this be the case with your group, be aware of potential “time gaps” and costume conflicts. We will not be able to guarantee requested time spots. Please direct all scheduling questions or conflicts (via e-mail) to Stacy Becker in our San Antonio office: stacy@showmakerscamps.com.

7. **Props:** Each school is responsible for securing props. There will not be a storage area in San Marcos for overnight storage of props. If you are attending another contest location, please contact the host school director regarding prop location at their school. All props **MUST BE WELL-PADDED** to protect the floor. This applies to stage sets, etc. Teams that do not comply with this rule **WILL NOT BE ALLOWED TO PERFORM THEIR ROUTINE**. All large props not fitting through the door in San Marcos must be unloaded at the loading dock located near the spectator entrance. At Strahan Coliseum, props must be unloaded at the time of the prop category. Following the prop division, all props must leave the area due to fire regulations and lack of storage space. At all other locations, the school boosters will be available to assist you with props and storage. **Our office MUST be notified in advance (prior to scheduling...2 weeks) if additional setup time is needed.** This will prevent the contest from running behind schedule! ► **Please be sure and read the rules listed in the contest brochure.** Please direct all scheduling questions or conflicts (via e-mail) to Stacy Becker in our San Antonio office: stacy@showmakerscamps.com.

8. Finalists for solo competition will be announced around noon on Saturday at all contest locations. Top High School finalists will perform (only if score average is 93+) their routine prior to the awards ceremony. The **WINNER** only will perform (if score average is 93+) from Elementary through Jr. High. **Reminder:** High School solos will be divided as 9th & 10th / 11th & 12th. The top High School finalists will be ranked after their final performance and not scored. Trophies will be awarded to 1st, - 5th place winners in all age divisions: K-3, 4-6, Jr. High (6-8 or 7-9), and High School (9-10 & 11-12). High School will include Pep, Drill, JV, Elite, Private and Parochial. Soloists receiving superior ratings (85+ average) will be awarded a medal.

9. Entrance and exit will not be judged. Teams should move on and off the floor as quickly as possible.

10. No helium balloons allowed in the athletic complex. No special effects which include smoke or chemicals, dry ice, hay bales, confetti or powder will be allowed. Special effects with the potential to

cause harm to performers or spectators are prohibited. E-mail our office for clarification on rules or fire regulations set by the city.

11. Score sheets and **Video/Flash Drive critiques** for all competition categories will be given to the DIRECTOR ONLY at the conclusion of the contest. Please do not send students or parents to pick up this packet. Those soloists and ensembles receiving a Division I for their performance will receive a medal enclosed in the director packet. NO PACKETS WILL BE GIVEN PRIOR TO THE ANNOUNCEMENT OF AWARDS unless advance notice of an early departure is given. **ShowMakers will not ship awards or contest packets.** Please notify the contest administrator and make arrangements to pick up your awards and results before you leave the premises.

12. Sample score sheets are enclosed.

13. The competition will be professionally videotaped by **Action Video Productions**. **ShowMakers®** has nothing to do with video packages, etc. These packages will be available for purchase at each contest location. **Make sure** you retain a receipt upon purchase. Spectator videotaping will not be allowed at the railings or walkway areas. Spectators may not set up tripods. For safety and liability reasons, spectators MAY NOT PLUG EQUIPMENT INTO ELECTRICAL OUTLETS. Due to fire regulations, walkways must be kept clear. DO NOT SET UP VIDEO CAMERA IN THE ACTION VIDEO AREA. PLEASE INFORM PARENTS IN ADVANCE TO PREVENT CONFLICTS.

14. Floor/complex layout for each contest location is enclosed. Please note where teams are “on deck” for entrance and exit. Be aware that “on deck” areas can become congested. Have your team prepared. NO HARD-SOLED SHOES ALLOWED on the gym floors without protection (to include but not limited to character shoes).

15. No walking will be allowed floor level during a performance. As a courtesy to performers, judges, and the viewing audience, we ask that you sit during each performance and do not walk or stand while a performance is in action.

16. The **ShowMakers®** office will be closed Friday of each contest. Should you need assistance, we ask that you **e-mail** the day prior.

17. Concessions will be sold throughout the day at all contest locations. At high school locations, the booster clubs have fantastic menus planned. NO OUTSIDE FOOD OR DRINKS WILL BE ALLOWED AT ANY CONTEST LOCATION. No food will be allowed in the dressing areas.

18. Please refer to the previously sent contest brochure or online: (www.showmakerscamps.com) for a listing of awards and general contest guidelines.

19. Please inform parents and supporters not to sit in the judging or Action Video area. (Yes, it happens every year!) In the solo areas at each contest location, students/parents may not videotape behind the judges. (This happens every year!) You can help us out by informing your parents etc., in advance.

20. **REMINDER: HAVE ALL MUSIC TAPES/CD'S LABELED/CUED/READY TO PLAY. REMEMBER TO PICK UP MUSIC FOLLOWING PERFORMANCES. THERE IS NO GUARANTEE THAT MUSIC LEFT AT THE CONTEST WILL BE RETURNED.**

21. Reminder: Please notify our office in advance via **e-mail** if an additional director will be attending.
22. **STUNTS/TUMBLING: ShowMakers®** does not encourage the use of tumbling or unsafe stunts in routines. Spotters will not be provided. Any jumping, flipping or falling off pyramids or props is **prohibited**. All pyramids and partner stunts are limited to two persons high. All bases must have direct weight bearing contact with the ground. All single or double-based extended stunts must have a continuous spotter. All gymnastic stunts must originate from ground level. E-mail our office for clarification.
23. Texas State University has requested that teams performing wear a non-marring shoe on the court. Please e-mail the **ShowMakers®** office should you need specific details.
24. **Contest Store: ShowMakers®** will have T-shirts and patches available for purchase at all contest locations. T-shirts, hoodies, and jackets ranging from \$12.00 - \$25.00 / Contest Patches \$5.00 & \$6.00. *Patches sell out fast! Do not wait to buy...we cannot guarantee that we will have patches in stock following contest season. These items cannot be ordered by individually or by parents.
25. Should you have special time requests, please e-mail 2 weeks prior to contest date. **All requests or changes must be in writing (do not leave a verbal message)**. Requests are based on “first come, first serve”. If you register late we cannot guarantee preferred performance time. **Please direct all scheduling questions or conflicts** (via e-mail) to **Stacy Becker** in our San Antonio office: stacy@showmakerscamps.com.
26. For directions to contest locations: www.mapsonus.com or www.mapquest.com. (See address on contest location specification sheet.) Please inform parents, etc., NOT to call the host school or ShowMakers office for directions.
27. **Dressing Facilities:** See specifics listed under each contest location.
28. **Inclement Weather:** In the event that we experience inclement weather on contest day, it is advisable to wait until roads are clear and driving is not hazardous. Directors, if able, please call to notify and keep the host director updated on your situation.
29. **Flu Symptoms:** In 2009, many schools and businesses around the nation were hit hard by the spread of the H1N1 virus. We still face the possibility that there will be another outbreak from January through April that will cause numerous absences from school and dance class. With this in mind, ShowMakers will not penalize a team for routines performed with obvious holes in a formation. We do request that you notify our office in writing (via e-mail) of your situation so that we can make all appropriate preparations.

Contest Rules

Team Size Rule

Varsity Public High School Dance Teams classified by team size (Extra Small, Small, Medium, Large, Extra Large), must determine their size by reporting **actual number of members on their team** and not how many members will be competing at the competition. Contest administrators may elect to further divide some of these team categories that have a large number of participants. Changes in team

size must be made in writing three weeks before the contest and signed by your administrator. No changes in team size will be made after the schedule is sent out.

Routine Performance Requirement

Varsity Public High School Dance Teams must perform a minimum of 70% of their actual team membership on all team routine events entered. Any team that elects to perform less than 70% will be placed in the Elite category.

Props and Backdrop Usage

Curtains, staging, and other props for routines should be constructed to fit through a 7 foot tall double door, with the center support bar removed, found at most public school gymnasiums where regional contests are held. Props and staging may have minor assembly on the floor but setup and breakdown time for props and staging will be added to the actual routine performance time length to produce total floor time. Total floor time should not exceed 5 minutes for all dance categories except show production (10 minutes). Any exceptions must be approved by the contest administrator, in advance of the competition.

Performance Schedule

A 5 point penalty will be assessed to teams not ready to perform when scheduled unless delay is caused by a technical problem in the competition. This will be determined by the officials conducting the competition. If the competition is running ahead of schedule, teams will have the option of performing early or waiting until their scheduled time but no later.

Late Entry Penalties

Any entries received after the registration deadline (10 days prior to contest date) will be charged a **\$25 late fee** for each team, officer, ensemble, and solo entered if the contest schedule is complete upon receipt of the entry.

Late Cancellations

Any team that drops events after the schedule has been made will still be responsible for those entry fees unless cancellation has been approved by the contest administrator.

IMPORTANT! PLEASE READ Contest Recordings

We have experienced some problems with CD recordings at our contests. Please be aware that some CD recordings will not always play on high-tech machines. Due to the sensitivity in reading CD's on professional sound equipment, it is imperative that you check your music prior to use of professional CD players AND have a back-up cassette tape available. **Not all players read MP3 files.** Please plan accordingly. We ask that you adhere to the following guidelines:

- Be aware that inexpensive and large chain store recordable CD's are less reliable (ex. Office Depot, Best Buy, Memorex).
- Make sure when burning audio tracks that the entire disc is **finalized** and not just the individual session/track. This ensures the track number and audio time displayed.
- If recording in mixed media mode (data & audio) it could cause the CD player to have difficulty in reading the disc and display an error message during playback.
- Be aware that the audio sessions burned/recorded on a personal computer using a program that is selected to playback only on a personal computer, could cause the CD player to have difficulty in reading the disc and will display an error message.
- Please have a copy of your music placed on tape cassette as a back-up. Make sure the tape is with you at the sound table during the performance.

TEXAS STATE DANCE/DRILL TEAM CHAMPIONSHIP

► **Contest fees due prior to contest date. Schools will be taken off the schedule if payment is not received! Fees will not be accepted at the door.**

1. Ensemble/Solo competition will be held Friday, February 17th at Texas State University-San Marcos. Registration will be held in Strahan Coliseum with doors opening at **3:30 pm. (not before). The contest will begin at 4:00 pm.** Solo/Ensemble competition will be held in Strahan Coliseum and Jowers Gym 101.
2. On Friday/Saturday, the lower level bleachers will be pulled out on all sides of the Coliseum. All routines must be choreographed within the boundary lines as there **will not** be overflow.
3. Team/Officer competition will be held on Saturday, February 18th. Doors will open at **7:00 am. (not before)** with contest start time at **8:00 am.** Teams may have floor spacing before contest and during all break intervals. Please keep in mind that many schools would like to use the floor. We ask that you limit your time to floor spacing and formation changes only. Move on and off as quickly as possible.
4. The dressing facilities are located in Jowers Center (near the P.E. gym area). **Please DO NOT leave or store costumes in these facilities as it is an unsecured area.** Use this facility for changing only! There are many restroom facilities located around the Coliseum and Jowers Center to accommodate everyone. Do not linger and apply makeup. **Do not leave valuables unsupervised!** We ask that you leave costumes and travel bags on the bus to ensure safety. **Groups will be assigned areas to use on Saturday and will be sharing with other schools.** Please notify our office via e-mail if you have male performers. As a courtesy to the other schools, we ask that all male performers stay out of female dressing areas.
5. **PROPS:** All large props will be received at the loading dock prior to the scheduled performance. These props will be loaded into a freight elevator and lowered to the floor level. (Freight elevator approx. 8X10 and 7-8 feet high.) **E-mail** the ShowMakers office should you have questions regarding prop size, etc. Please review the prop information specified in **General Contest Information.** Props are to be brought in at the time of the category. Props that are not properly protected (even if only a stage set) **will not be allowed onto the floor. The University will make no exceptions to this rule. We would not enjoy refusing a team's performance due to lack of reading the rules. All props will be checked!**
6. On Friday/Saturday, one P.E. gym (Gym 102) will be available for practicing along with the outside area around the coliseum. This gym will be an area for prop assembly and easy access to and from the loading dock.
7. Concessions will be open on both days. In addition, there are many food establishments near the contest site. G&M Catering is offering a meal plan for those that wish to preorder lunch and dinner. Please see attached form.
8. For directions to Texas State University 601 University Drive San Marcos, TX 78666:
www.mapsonus.com or www.mapquest.com.

► **READ GENERAL CONTEST INFORMATION FOR ADDITIONAL RULES & REGULATIONS.**

► **ABSOLUTELY NO OUTSIDE FOOD/DRINKS/ICE CHEST WILL BE ALLOWED INSIDE THE ATHLETIC COMPLEX! NO EXCEPTIONS!**

2012 Texas State Championship Competition Boxed Meal Program

Due to the **NO OUTSIDE FOOD OR BEVERAGE POLICY** in place at Strahan Coliseum, we are offering your group the convenience of our high-quality boxed meals.

**Orders are due via fax by Wednesday, February 8, 2012,
to (512) 929-8307**

We require a credit card number at the time your order is placed, but payment to G&M Catering can be made with cash or check when you pick up your order. The meal pickup will be at Concession Stand # 4 at Strahan Coliseum. We ask that you send a representative to pick up your group meals at the times posted below.

Name of School: _____
Name of Director: _____
School Phone: _____
Credit Card No: _____
Expiration Date: _____
Method of payment: _____

Please indicate which meal time(s) you are purchasing.

- Friday 2/17/12 Dinner @ 6:00 pm**
- Saturday 2/18/12 Lunch @ 12:00 pm (Noon)**
- Saturday 2/18/12 Dinner @ 6:00 pm**

Option 1: Ham & Cheese Sandwich on a Croissant with Lettuce and Tomato
Individual Bag of Chips
*Two (2) Assorted Cookies \$7.50 each **Order:** _____

Option 2: Turkey & Cheese Sandwich on a Croissant with Lettuce and Tomato
Individual Bag of Chips
*Two (2) Assorted Cookies \$7.50 each **Order:** _____

Option 3: Mixed Cut Sandwich (Turkey, Ham, Roast Beef) with Lettuce, Tomato, and Sliced Cheese
Individual Bag of Chips
*Two (2) Assorted Cookies \$8.00 each **Order:** _____

*You can exchange whole fruit for the cookies at no additional charge.

Questions? Please contact Misty @ 512.929.8305 or misty@gmcatering.com.

Thank you!
G&M Catering

▶ Do not contact the ShowMakers office regarding orders.

Strahan Coliseum / Jowers Center

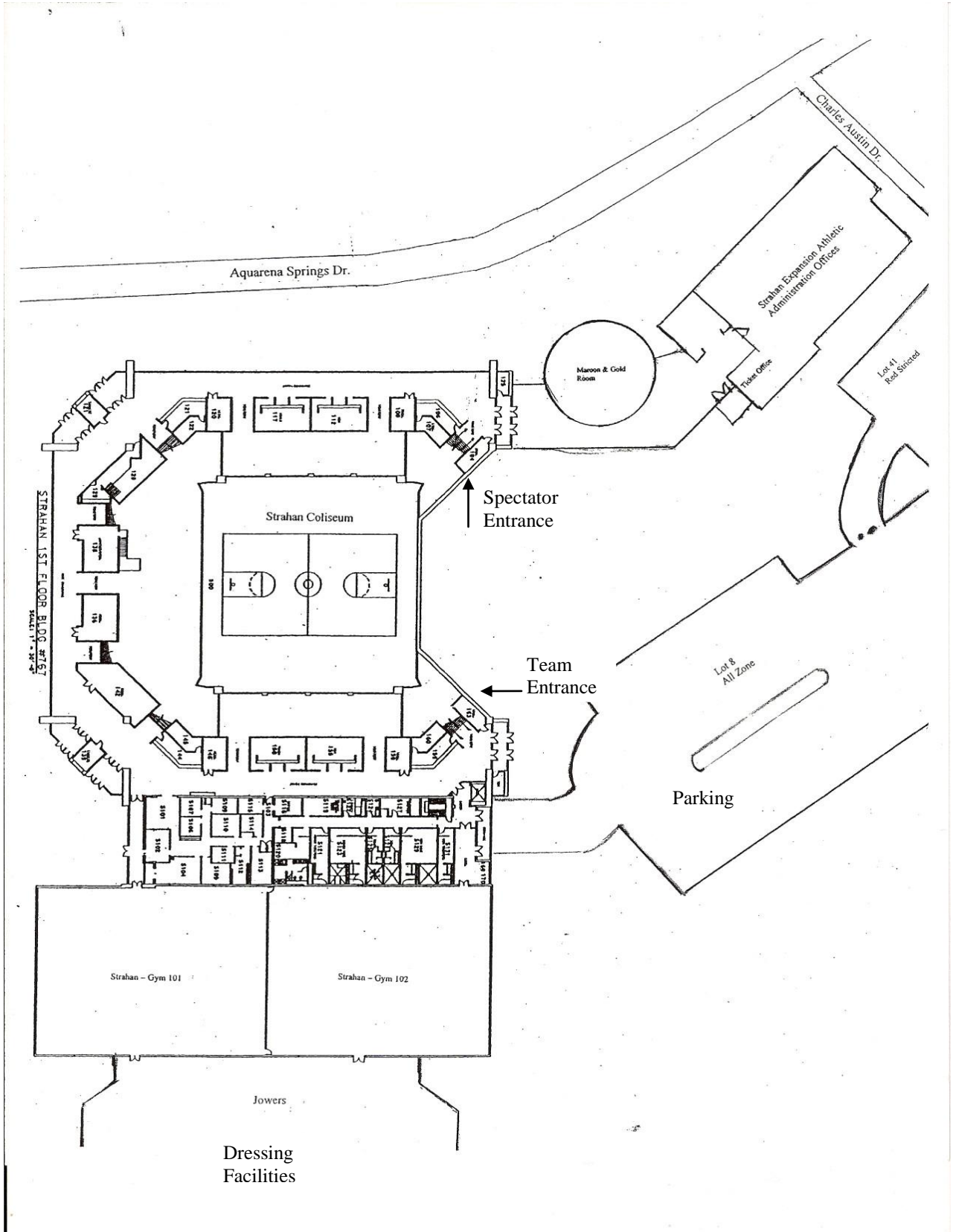

Strahan Coliseum

Enter from Tunnel

Team Seating



Sound

Judges

Exit Upstairs

Spectator Seating

ShowMakers of America®

Team / Officer / Ensemble

SCHOOL	CLASSIFICATION / CATEGORY	MAX POINTS	SCORE
APPEARANCE	<input type="checkbox"/> Uniform/Costume <input type="checkbox"/> Grooming <input type="checkbox"/> Costume Suitability	10	
CHOREOGRAPHY	<input type="checkbox"/> Variety of Movement <input type="checkbox"/> Transitions <input type="checkbox"/> Difficulty <input type="checkbox"/> Formations <input type="checkbox"/> Creativity/Originality <input type="checkbox"/> Use of Floor Space <input type="checkbox"/> Musical Selection <input type="checkbox"/> Floor Levels <input type="checkbox"/> Music Interpretation	25	
TECHNIQUE / EXECUTION	<input type="checkbox"/> Extensions <input type="checkbox"/> Posture <input type="checkbox"/> Leaps <input type="checkbox"/> Body Alignment <input type="checkbox"/> Turns <input type="checkbox"/> Uniformity of Kicks <input type="checkbox"/> Control <input type="checkbox"/> Kick Technique <input type="checkbox"/> Footwork <input type="checkbox"/> Transitions <input type="checkbox"/> Use of Prop	25	
PRECISION	<input type="checkbox"/> Uniformity of Movement <input type="checkbox"/> Timing <input type="checkbox"/> Spacing/Alignment/Formations	20	
SHOWMANSHIP	<input type="checkbox"/> Attitude <input type="checkbox"/> Audience Appeal <input type="checkbox"/> Poise <input type="checkbox"/> Focus/Eye Contact <input type="checkbox"/> Projection <input type="checkbox"/> Energy Level	20	
TOTAL SCORE		100	
PENALTIES	Explanation:		

85 – 100 = I SUPERIOR

70 – 84 = II EXCELLENT

55 – 69 = III GOOD

√ Excellent / — Needs Improvement

▶ Blank indicates good

TOTAL POINTS _____

RATING _____

JUDGE _____

ShowMakers of America®

Solo Score Sheet

NAME	SCHOOL	MAX POINTS	SCORE
APPEARANCE	<input type="checkbox"/> Costume <input type="checkbox"/> Posture <input type="checkbox"/> Grooming <input type="checkbox"/> Costume Suitability	10	
CHOREOGRAPHY	<input type="checkbox"/> Variety of Movement <input type="checkbox"/> Difficulty <input type="checkbox"/> Creativity/Originality <input type="checkbox"/> Skill Level <input type="checkbox"/> Musical Interpretation <input type="checkbox"/> Transitions <input type="checkbox"/> Use of Floor <input type="checkbox"/> Music Selection	40	
TECHNIQUE / EXECUTION	<input type="checkbox"/> Extension <input type="checkbox"/> Leaps <input type="checkbox"/> Turns <input type="checkbox"/> Kick Technique <input type="checkbox"/> Body Placement <input type="checkbox"/> Footwork <input type="checkbox"/> Control/Balance <input type="checkbox"/> Energy Level <input type="checkbox"/> Timing <input type="checkbox"/> Memory <input type="checkbox"/> Transitions	40	
SHOWMANSHIP	<input type="checkbox"/> Attitude <input type="checkbox"/> Focus/Eye Contact <input type="checkbox"/> Audience Appeal <input type="checkbox"/> Confidence/Composure <input type="checkbox"/> Projection <input type="checkbox"/> Energy Level	10	
TOTAL SCORE		100	
PENALTIES	Explanation:		

85 – 100 = I SUPERIOR
 70 – 84 = II EXCELLENT
 55 – 69 = III GOOD

TOTAL POINTS _____

RATING _____

► Blank indicates good
 ✓ Excellent / — Needs Improvement

JUDGE _____

ShowMakers of America

General Contest Information for Spectators & Participants

Contest Admission / Complimentary Tickets

Friday – Cost \$8.00 / VIP passes should be presented at the spectator gate

Saturday – Cost \$10.00 / VIP passes should be presented at the spectator gate

*Participants/managers must be in uniform to be admitted free of charge / Children under 4 admitted free

Maps/Direction

- ✓ Please visit our website www.showmakerscamps.com for a link to Map Quest or Maps on Us (www.mapquest.com or www.mapsonus.com)

Contest Program / Schedules

- ✓ Paying spectators will receive a complimentary schedule at the contest site.
- ✓ Directors will be e-mailed a preliminary contest schedule 3-5 days prior to the contest. The schedule will NOT be posted online until the day of the contest. Please contact your high school director for an advance look at the schedule.
- ✓ Participants must obtain a schedule from their director. Programs will not be given to participating students.
- ✓ Be prepared for the contest to run ahead of schedule.

Dressing Facilities

- ✓ Dressing rooms will be assigned to teams attending contests at the various high schools listed. Do not leave valuables unattended.
- ✓ All teams will share dressing facilities at the Texas State contest. Do not leave valuables or store costumes in the facility.
- ✓ Absolutely no men allowed in the dressing areas.
- ✓ No food or drink will be allowed in the dressing facilities.
- ✓ Participants will be required to follow the rules and regulations for the dressing facilities (listed in the contest handbook). Schools will be responsible for damages and clean-up.

Concessions / Food

- ✓ Absolutely **no** outside food, drinks, or coolers will be allowed inside the contest facility at any contest site.
- ✓ Complete concessions will be provided at each contest location.
- ✓ Spectators and participants must adhere to the specific food/drink guidelines set forth by the host school.

Contest Store

- ✓ **ShowMakers®** will have T-shirts and patches for sale at all contest locations.
- ✓ T-shirts & Sweatshirts will cost \$12.00-\$25.00 (Hoodie's / Jackets / Baby Tee's / Tanks / Regular Shirts) **Only cash or school check accepted.**
- ✓ Patches for contest and camp will cost \$5.00 / \$6.00
- ✓ It is best to purchase patches at the contest site. Availability will be limited following contest season and **cannot** be ordered online.

Video DVD's

- ✓ Action Video Productions will videotape the contest at all locations. A representative will be on hand in the foyer for video orders. ShowMakers has nothing to do with video orders or packages. **Please call Action Video at (800) 909-4723 / (817) 429-0929 concerning video packages.** Make sure you retain a receipt upon purchase.
- ✓ Spectators will not be allowed to plug video equipment into electrical outlets due to liability reasons. Tripods may not be set up in the aisles or spectator viewing areas.

Performances

- ✓ The performance side (judges) will be reserved for all paying spectators. Teams/participants must be seated on the opposite side or where designated.
- ✓ Spectators and participants will not be allowed to enter/exit the performance area or to stand during a performance. Fire Marshall Regulations state that all aisles must be kept clear.

Awards Presentation

- ✓ High School solo finalists will perform prior to the awards presentation along with the elementary and junior winner (only if receive a 93+). Awards will be announced immediately following the solo performances.
- ✓ Score sheets and Video/Flash Drive critiques will be given to the **director** following the awards presentation (not before). Directors are provided a list of the contest awards (located in the contest brochure/handbook or online at: www.showmakerscamps.com).